

WASTE-RIG : PUDU ETERNAL MARKET

Pudu: Essential City

Pudu Market once is an economic gem of Kuala Lumpur. People came to the historical wet market to find their vegetables, chickens, dairies and fishes. Until today, people come to Pudu for the same goods, and that's make the demands as the character of Pasar Pudu. But the time change, Pudu now discolored by some issues.

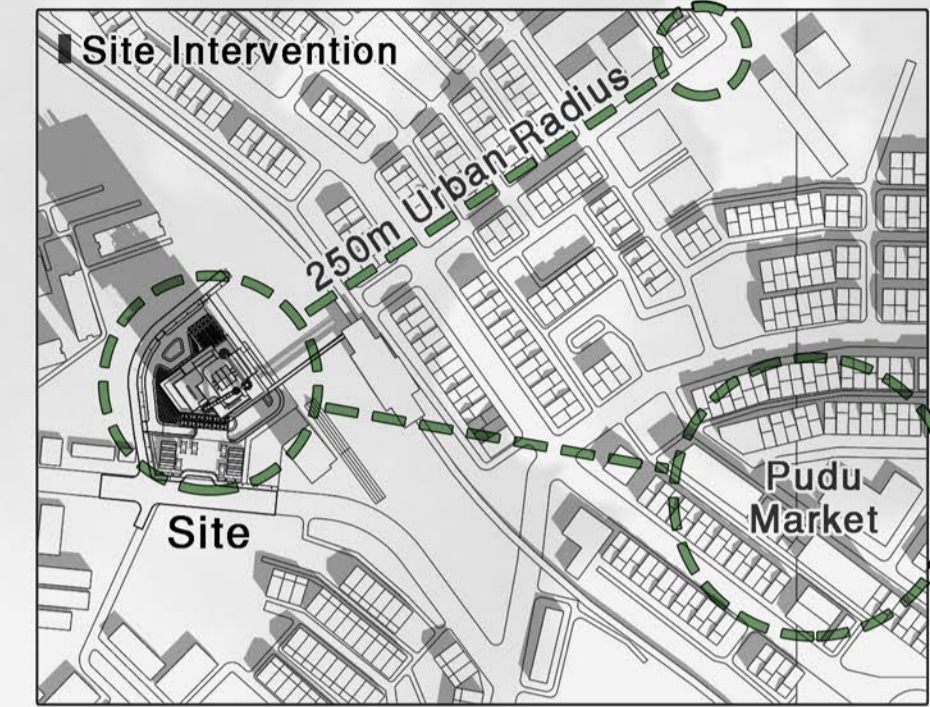
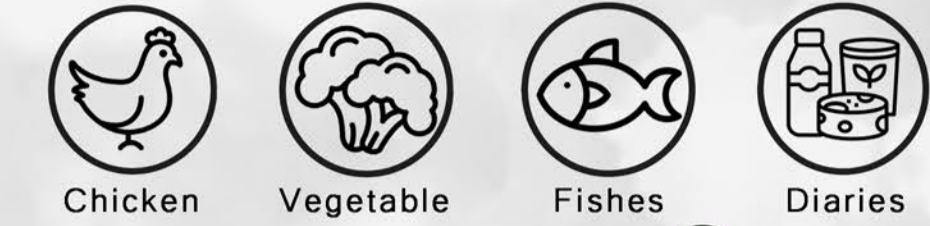

Stigma of the Place

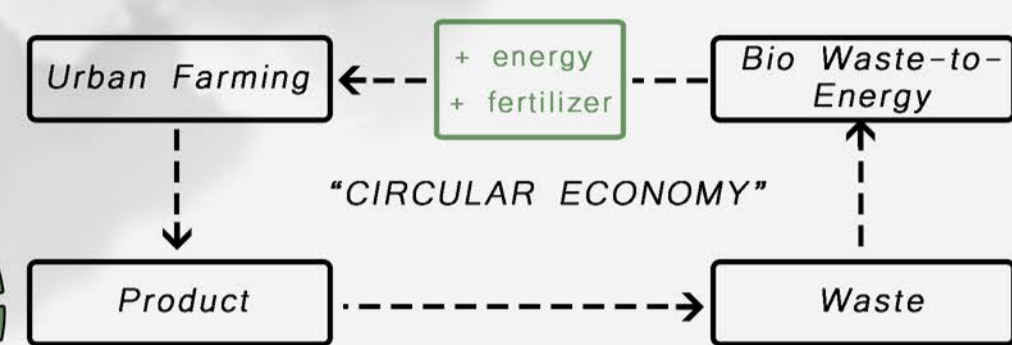
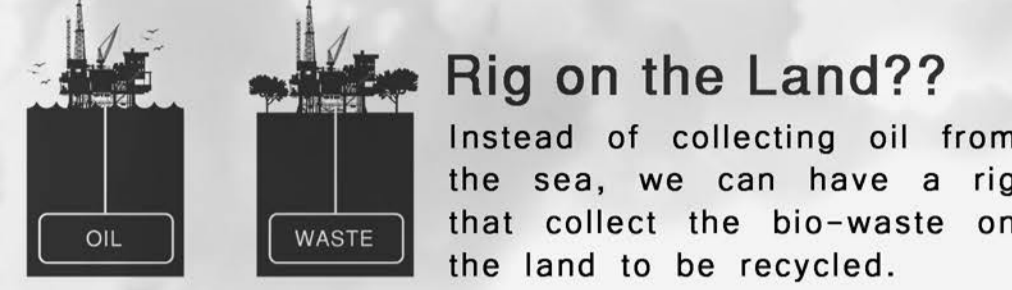

>100 bins of biowaste daily.
1,800 market stalls in Pudu.
11,700 sqm of wet markets in Pudu.
3,500 tonnes of bio waste daily Kuala Lumpur.
37% of Pudu population is migrants.
205 undocumented immigrants detained in March 2021

New Node, New Hope



From a dim city, this proposal changes Pudu to a city that pioneer other cities to achieve zero waste and sustainable living. And maintaining its character as an essential city that provide fresh goods.

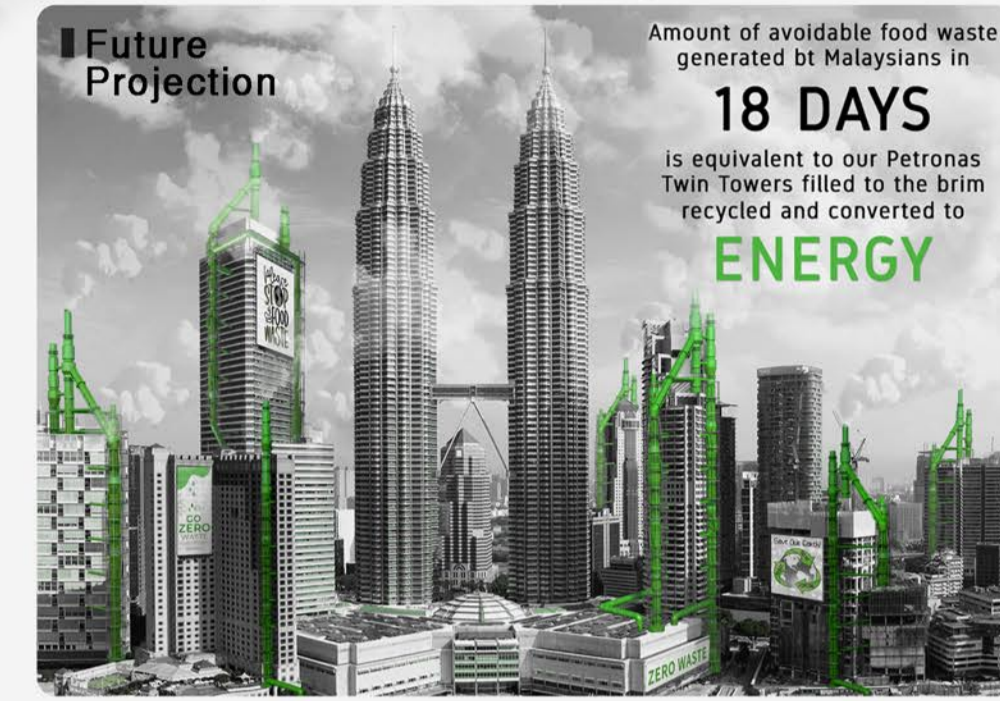

Waste-Rig Components

This tower is a symbol of biowaste-to-energy future, so it has to manifest the system with exposing its structure and services to the world.

"Hey look at me, i'm using biomass technology"

Diagram below shows the intergration between the building programmes, structure and services:

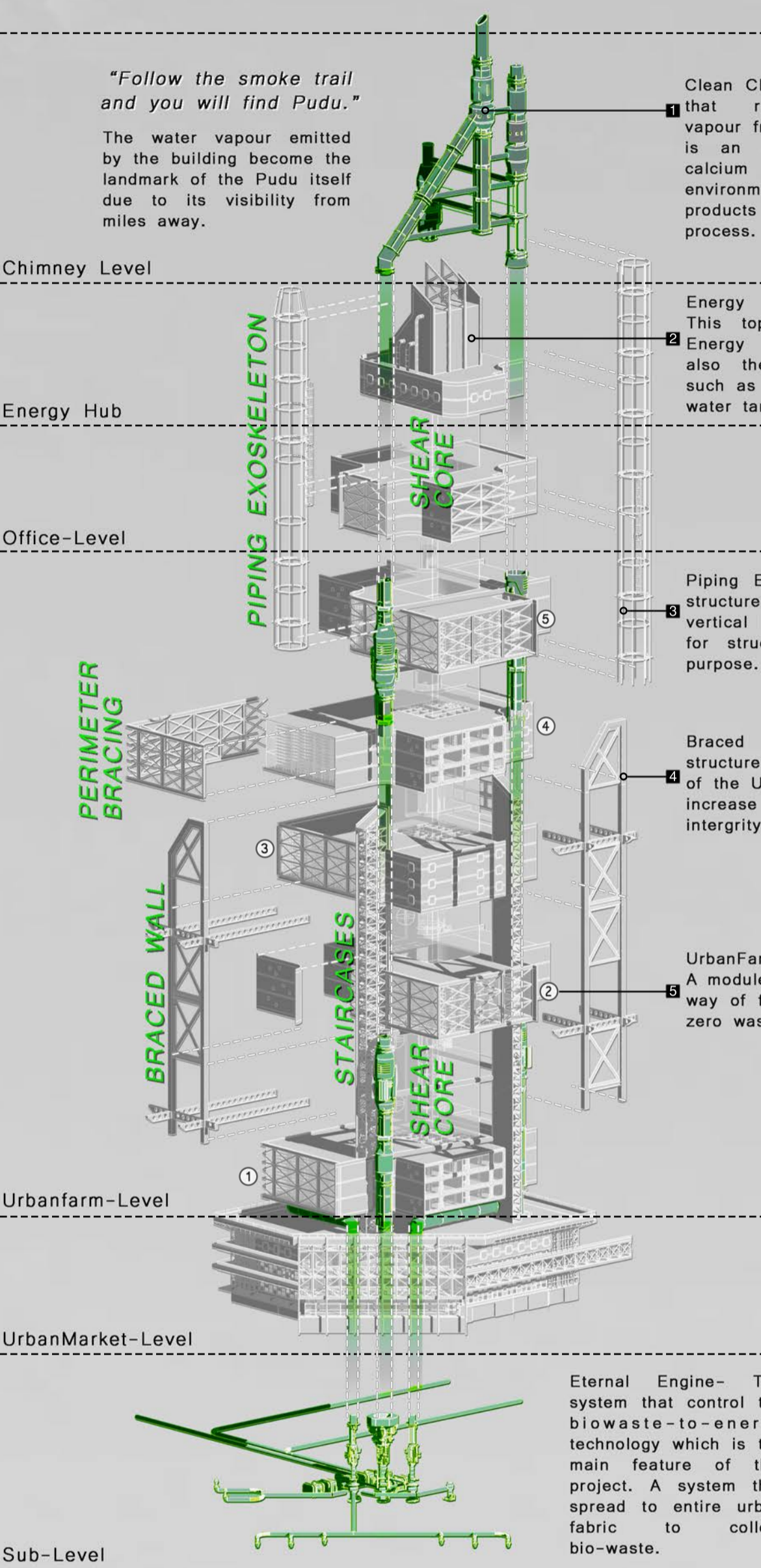

The Future of Zero Waste:



2578

Eternal Engine : Bio Waste-to-Energy

This building need a firm system to operate the whole programme in helping Pudu to achieve zero waste. An 'eternal system' can help the building operated to sustain the city, why not? But the challenge is how to translate the conventional biomass system into vertical arrangement.

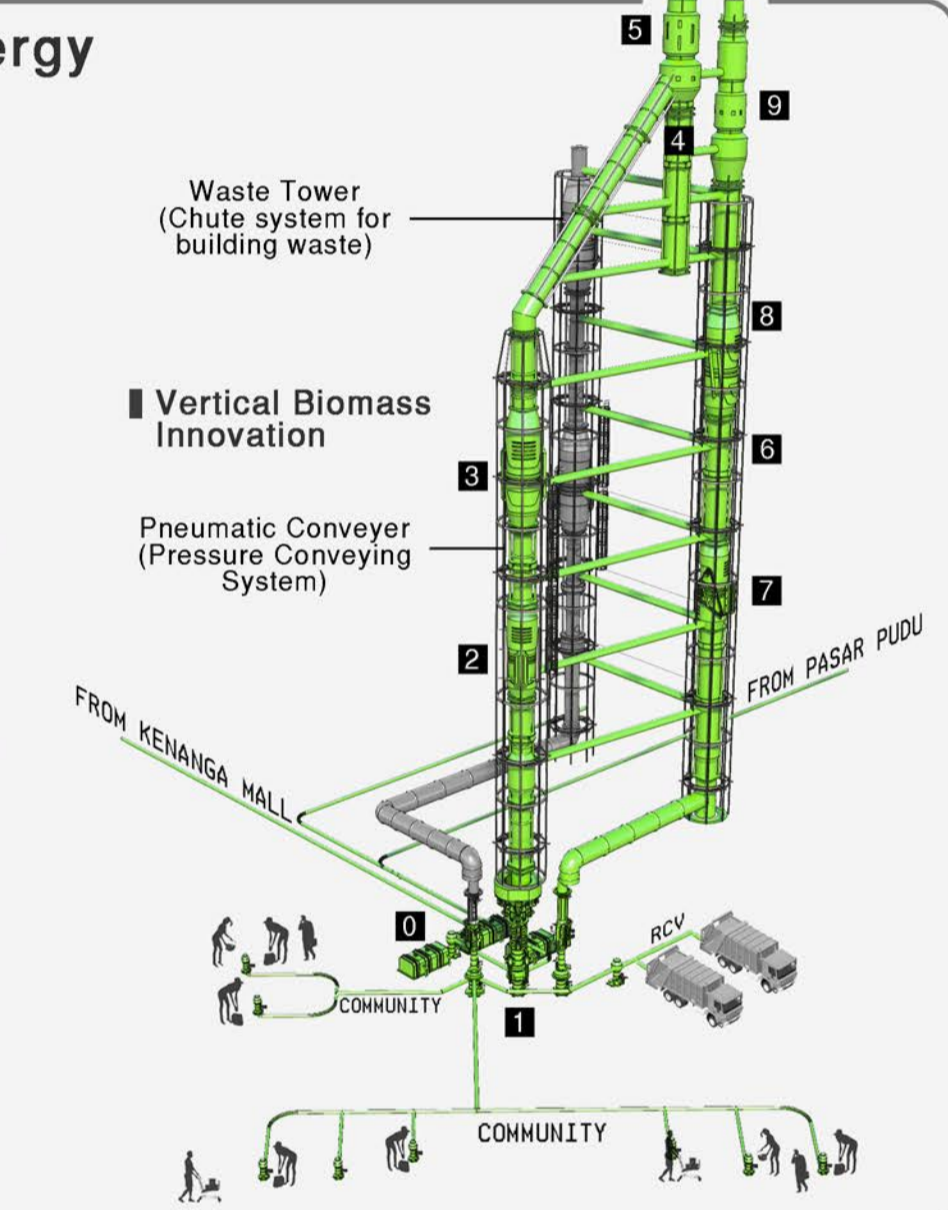
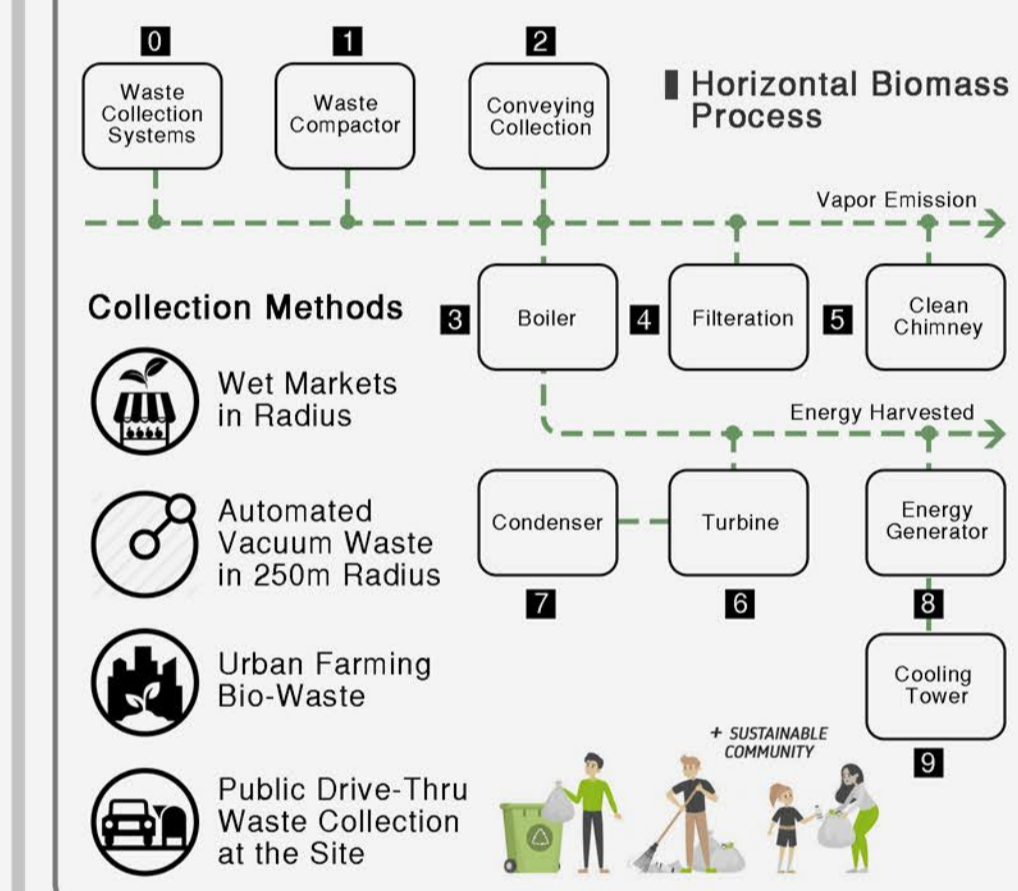

Future of Urban Farming!!

This integrated module give opportunities to the local companies to explore a new way of farming. The triple volume stacked urban farm attached to the office and R&D space to ease the operations. Integrated with the Eternal Engine, this module is the future of zero waste farming.

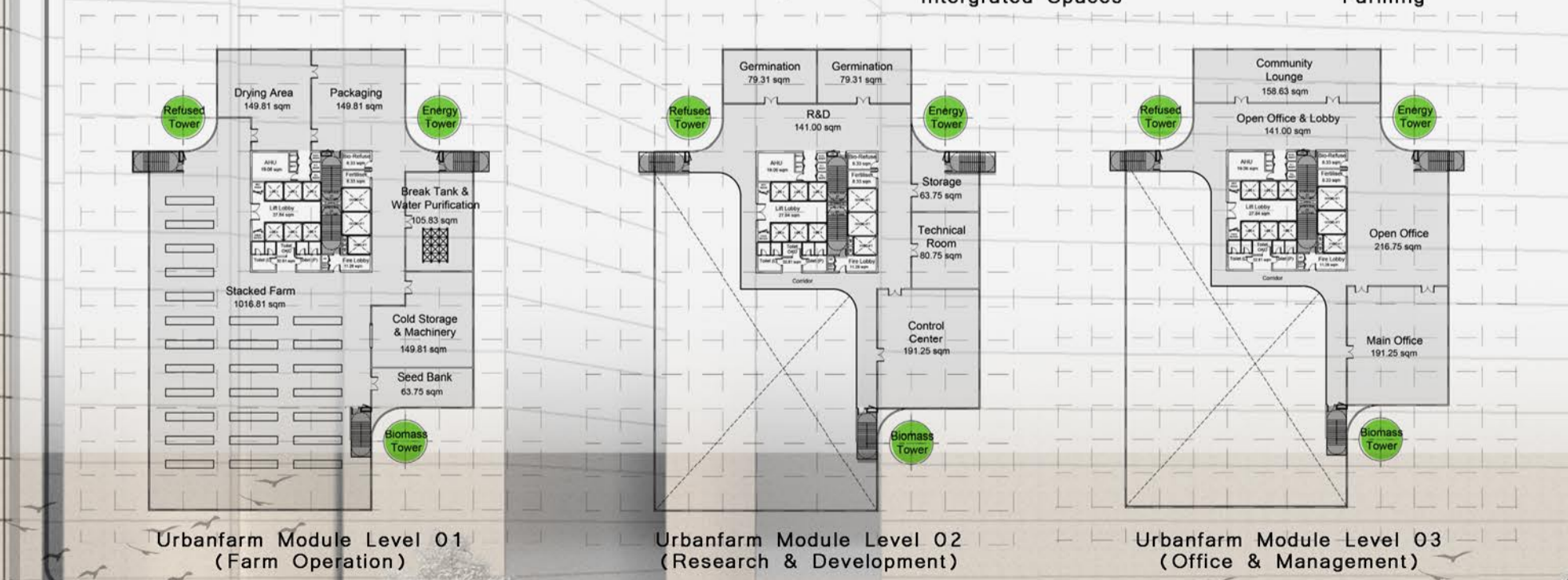

The Eternal Engine penetrating the atmosphere of Urban Market, a market completed with zero waste and smell features.

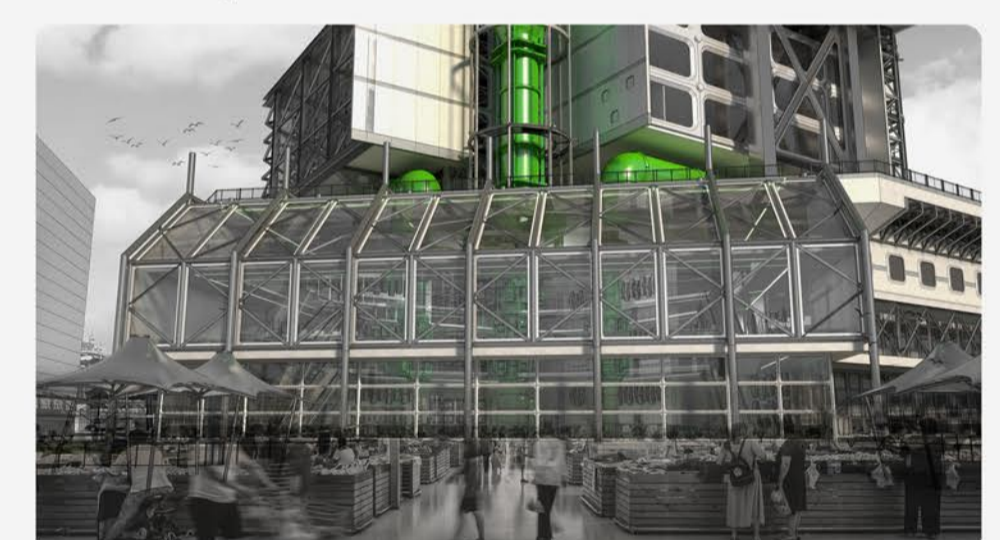

The Urban Market Plaza, a robust place for wet market activities which is completed with automated waste collection system.

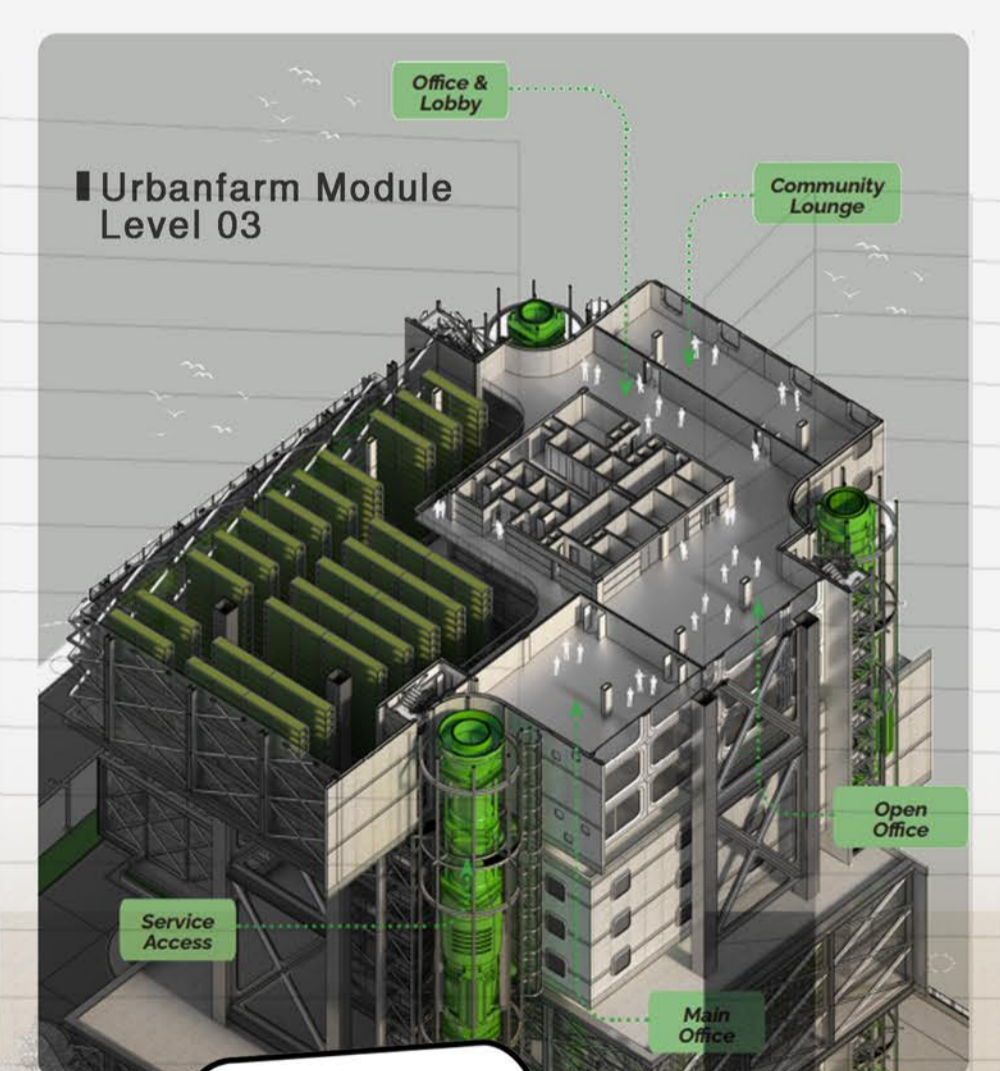

Structural Integrity

The outrigger system help the building to withstand lateral and gravity load. Perimeter bracing help the building to transfer the dead and live load efficiently form the building perimeter to the core and the ground.

